



FOCUS ON



Design ottimizzato e utilizzo di materie prime di elevata qualità per la realizzazione dei componenti
 Optimized design and high quality raw materials for the construction of the components



Manutenzione semplificata: i componenti con più probabilità di rottura sono disposti in zone accessibili per consentire anche interventi on-site
 Easy maintenance: the most fragile components are arranged in accessible areas to also allow on-site interventions

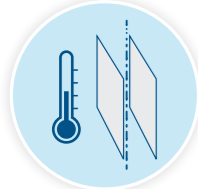

Corpo testa e corpo mandrino in ghisa per massimizzare rigidità e smorzamento durante le lavorazioni e design "termo-simmetrico" per gestire al meglio le dilatazioni termiche
 Head and spindle body in cast iron material to maximize stiffness and damping during machining and "thermo-symmetrical" design to better manage thermal variation dimensions

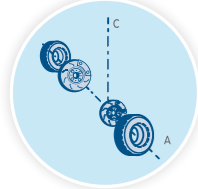

Doppio cuscinetto e doppio freno su asse A per rendere simmetriche le reazioni della testa
 Double bearing and double brake on A-axis to obtain head symmetrical reactions

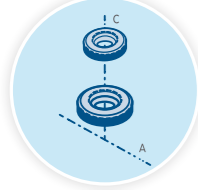

Cuscinetto di contro-supporto asse C (opzionale) per massimizzare la rigidità soprattutto nel montaggio in orizzontale
 C-axis double bearings (optional) to maximize stiffness especially in horizontal position assembly



Freni idraulici ad alta coppia di bloccaggio e rigidità
 Hydraulic brakes with high locking torque and stiffness

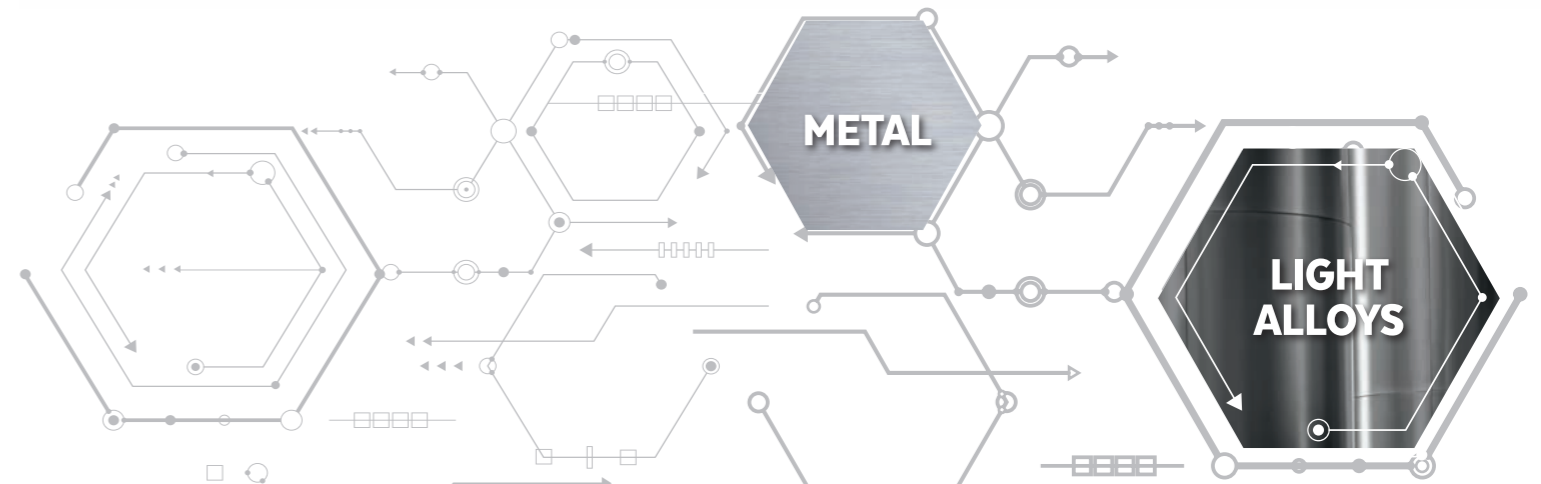

HITECO
 HIGH TECHNOLOGY COMPONENTS

ss 258 Marecchia, 34 47826 Villa Verucchio, Rimini - Italia
 tel. +39.0541.674940 - fax +39.0541.674962
www.hiteco.net

HITECO
 HIGH TECHNOLOGY COMPONENTS

TILT G

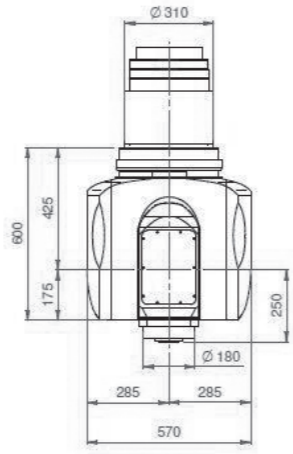

SPECIFICHE TECNICHE / TECHNICAL SPECIFICATIONS

	ASSE A / A AXIS	ASSE C / C AXIS
Motore asse / Axis motor	Direct drive	Direct drive
Coppia nominale / Rated torque	504 Nm	533 Nm
Coppia di picco / Peak torque	988 Nm	935 Nm
Max velocità rotazione / Max axes speed		30000°/'
Sistema di misura / Measuring system	Incremental encoder	Incremental encoder
Accuratezza scala / Accuracy of graduation	±2,5 arcsec	±2,5 arcsec
Azionamento freno / Type of clamping	Hydraulic	Hydraulic
Coppia di bloccaggio / Clamping torque	3000 Nm	3000 Nm
Max rotazione asse / Max axis rotation	±120°	±360°
Diametro di calettamento - testa / Head fitting diameter		Ø 310
Diametro di calettamento - mandrino / Spindle fitting diameter		Ø 180
Peso / Weight		500 kg

TILT M

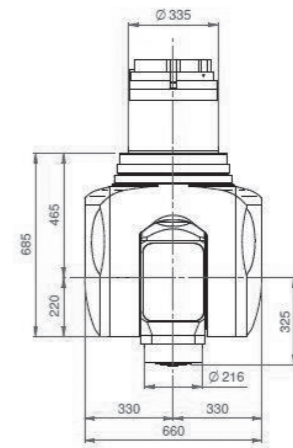

SPECIFICHE TECNICHE / TECHNICAL SPECIFICATIONS

	ASSE A / A AXIS	ASSE C / C AXIS
Motore asse / Axis motor	Direct drive	Direct drive
Coppia nominale / Rated torque	830 Nm	787 Nm
Coppia di picco / Peak torque	1472 Nm	1560 Nm
Max velocità rotazione / Max axes speed		30000°/'
Sistema di misura / Measuring system	Incremental encoder	Incremental encoder
Accuratezza scala / Accuracy of graduation	±2 arcsec	±2 arcsec
Azionamento freno / Type of clamping	Hydraulic	Hydraulic
Coppia di bloccaggio / Clamping torque	4000 Nm	4000 Nm
Max rotazione asse / Max axis rotation	±110°	±360°
Diametro di calettamento - testa / Head fitting diameter		Ø 335
Diametro di calettamento - mandrino / Spindle fitting diameter		Ø 210 (Ø 180)
Peso / Weight		800 kg

MX-2 42/12 28 63A ASYNCHRONOUS

SPECIFICHE TECNICHE / TECHNICAL SPECIFICATIONS

S1-S6 42-53 kW, S1-S6 34-43 Nm @12.000 rpm, 24.000 rpm (28.000 opt), kg 70, Ø 180, Motor ASYNCHRONOUS

EQUIPAGGIAMENTO / EQUIPMENT

- HSK 63A
- Liquid cooling
- Single effect hydraulic cylinder
- Ceramic ball bearings
- Automatic tool change (A.T.C)
- Labyrinth with air seal
- S1 S2 Sensors s1, s2
- Encoder TVpp
- Grease lubrication
- External tool cooling

OPZIONALI / OPTIONS

- Bearings temperature sensor
- Rotary joint
- Sensor S5
- Axial shaft displacement sensor
- Temperature monitoring
- Speed monitoring
- Vibration sensor
- Ball bearings oil lubrication

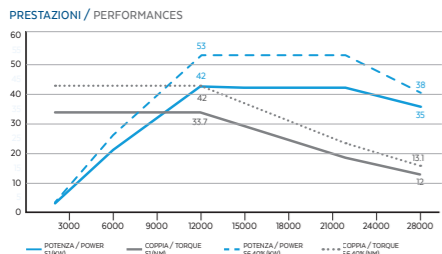

MX-2 42/6 24 63A SYNCHRONOUS

SPECIFICHE TECNICHE / TECHNICAL SPECIFICATIONS

S1-S6 42-52 kW, S1-S6 67-83 Nm @6.000 rpm, 24.000 rpm, kg 70, Ø 180, Motor SYNCHRONOUS

EQUIPAGGIAMENTO / EQUIPMENT

- HSK 63A
- Liquid cooling
- Single effect hydraulic cylinder
- Ceramic ball bearings
- Automatic tool change (A.T.C)
- Labyrinth with air seal
- S1 S2 Sensors s1, s2
- Encoder TVpp
- Grease lubrication
- External tool cooling

OPZIONALI / OPTIONS

- Bearings temperature sensor
- Rotary joint
- Sensor S5
- Axial shaft displacement sensor
- Temperature monitoring
- Speed monitoring
- Vibration sensor
- Ball bearings oil lubrication

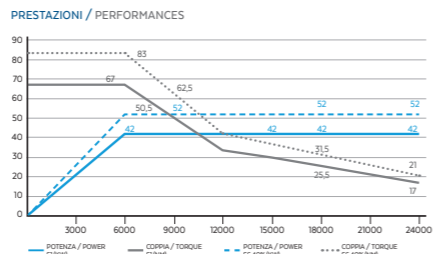

MX-2 42/6 24 63A SYNCHRONOUS

SPECIFICHE TECNICHE / TECHNICAL SPECIFICATIONS

S1-S6 42-52 kW, S1-S6 67-83 Nm @6.000 rpm, 24.000 rpm, kg 70, Ø 180, Motor SYNCHRONOUS

EQUIPAGGIAMENTO / EQUIPMENT

- HSK 63A
- Liquid cooling
- Single effect hydraulic cylinder
- Ceramic ball bearings
- Automatic tool change (A.T.C)
- Labyrinth with air seal
- S1 S2 Sensors s1, s2
- Encoder TVpp
- Grease lubrication
- External tool cooling

OPZIONALI / OPTIONS

- Bearings temperature sensor
- Rotary joint
- Sensor S5
- Axial shaft displacement sensor
- Temperature monitoring
- Speed monitoring
- Vibration sensor
- Ball bearings oil lubrication

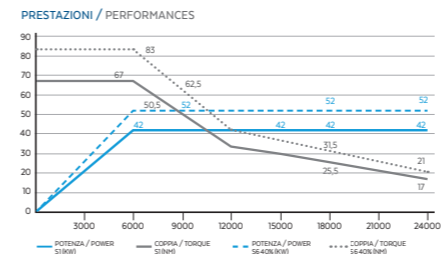

MX-2 47/3 15 100A SYNCHRONOUS

SPECIFICHE TECNICHE / TECHNICAL SPECIFICATIONS

S1-S6 47-54 kW, S1-S6 150-172 Nm @3000 rpm, 12.000 rpm (15.000 opt), kg 110, Ø 210, Motor SYNCHRONOUS

EQUIPAGGIAMENTO / EQUIPMENT

- HSK 100A
- Liquid cooling
- Double effect hydraulic cylinder
- Ceramic ball bearings
- Automatic tool change (A.T.C)
- Labyrinth with air seal
- S1 S2 Sensors s1, s2
- Encoder TVpp
- Grease lubrication
- External tool cooling

OPZIONALI / OPTIONS

- Bearings temperature sensor
- Rotary joint
- Sensor S5
- Axial shaft displacement sensor
- Temperature monitoring
- Speed monitoring
- Vibration sensor
- Ball bearings oil lubrication

